

**This electronic collection of documents is provided
for the convenience of the user
and is Not a Certified Document –**

**The documents contained herein were originally issued
and sealed by the individuals whose names and license
numbers appear on each page, on the dates appearing
with their signature on that page.**

**This file or an individual page
shall not be considered a certified document.**

2025CPT.12.17.20552

DL00328

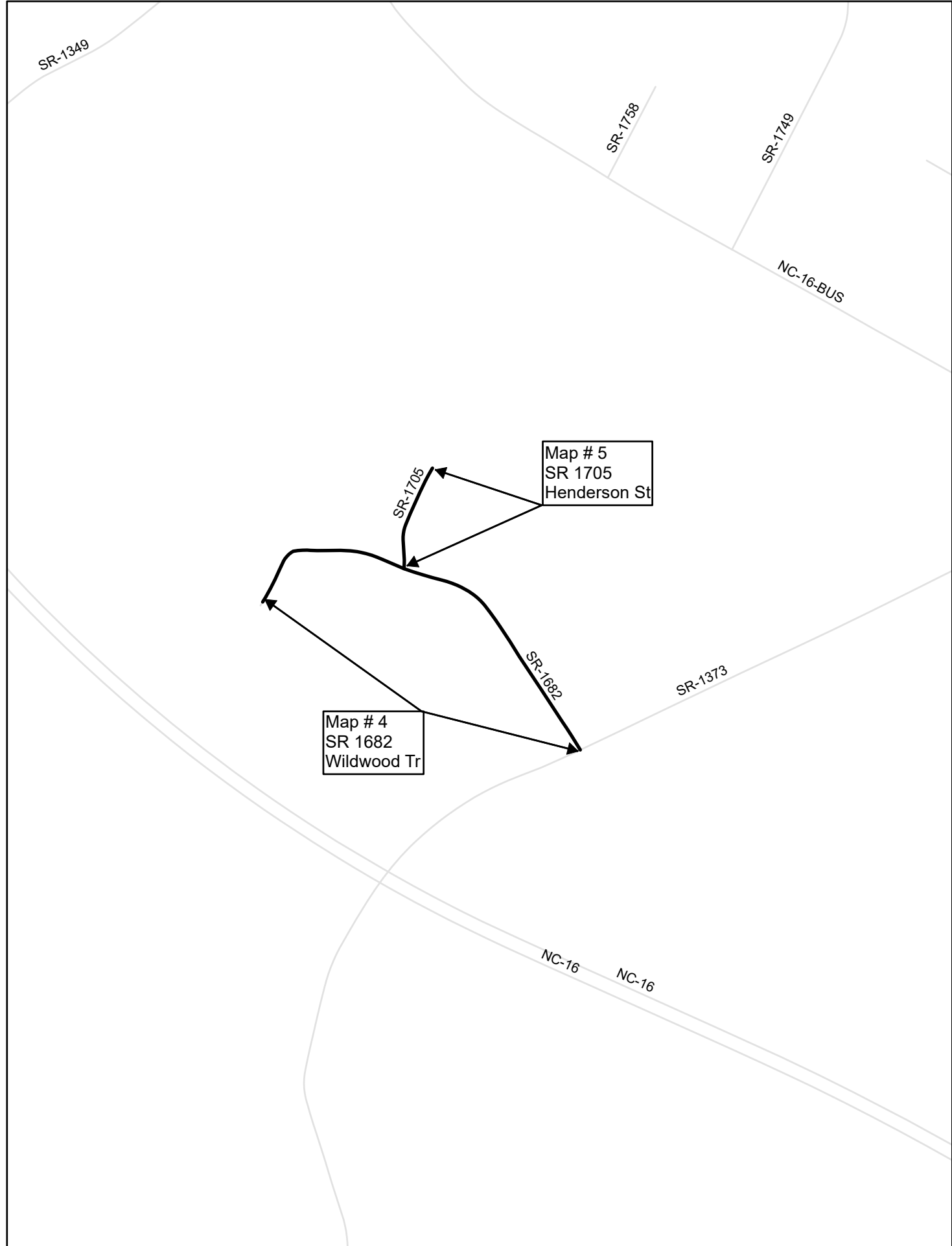
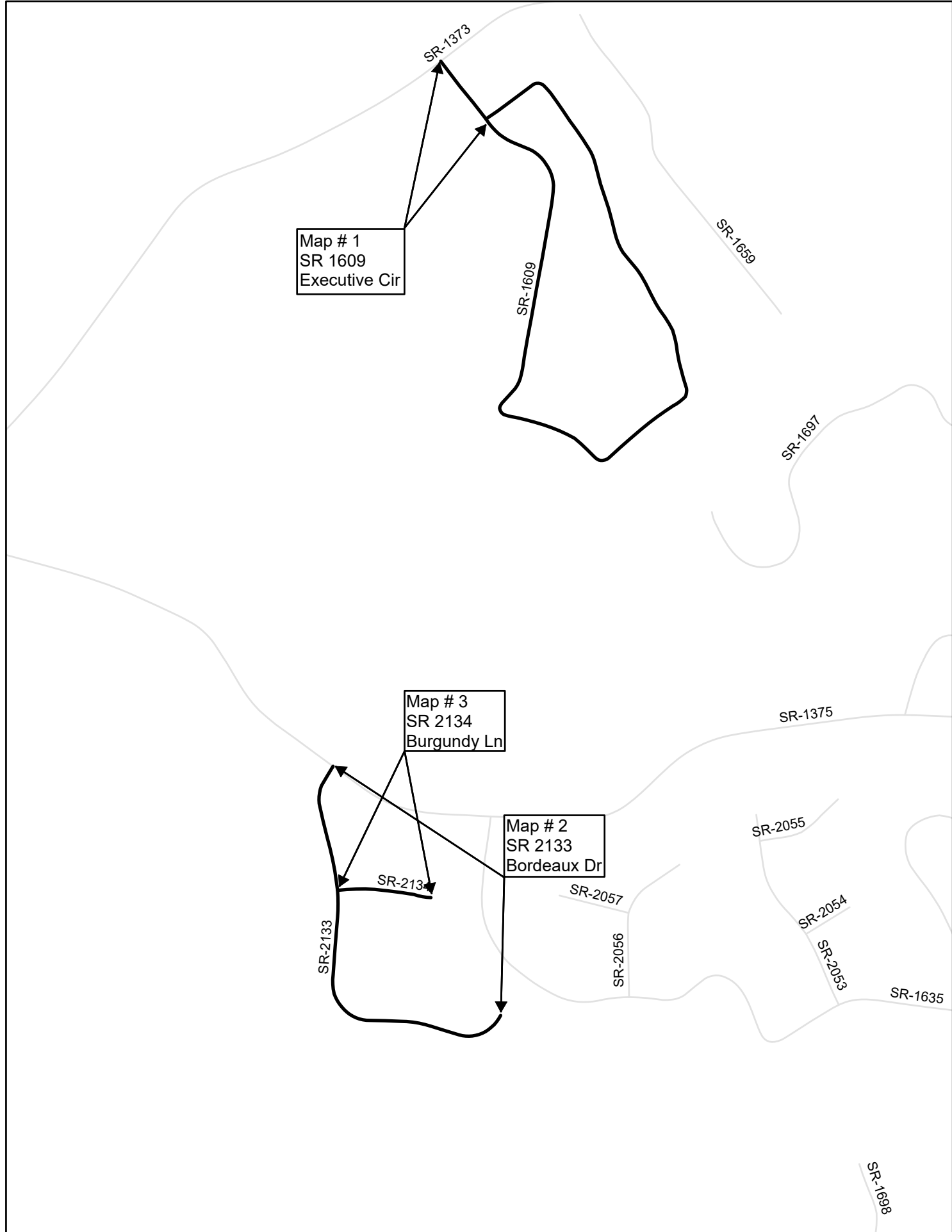

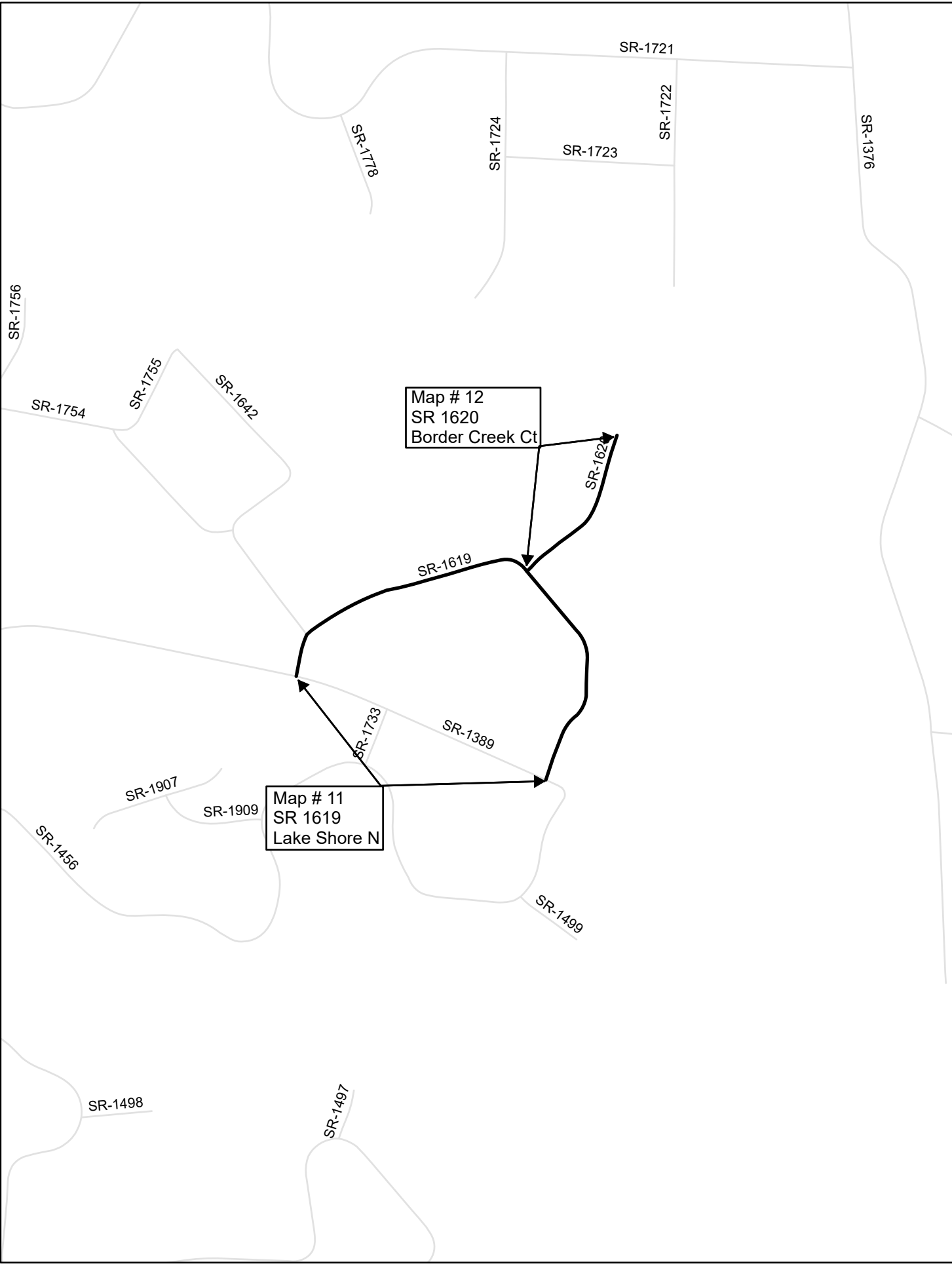
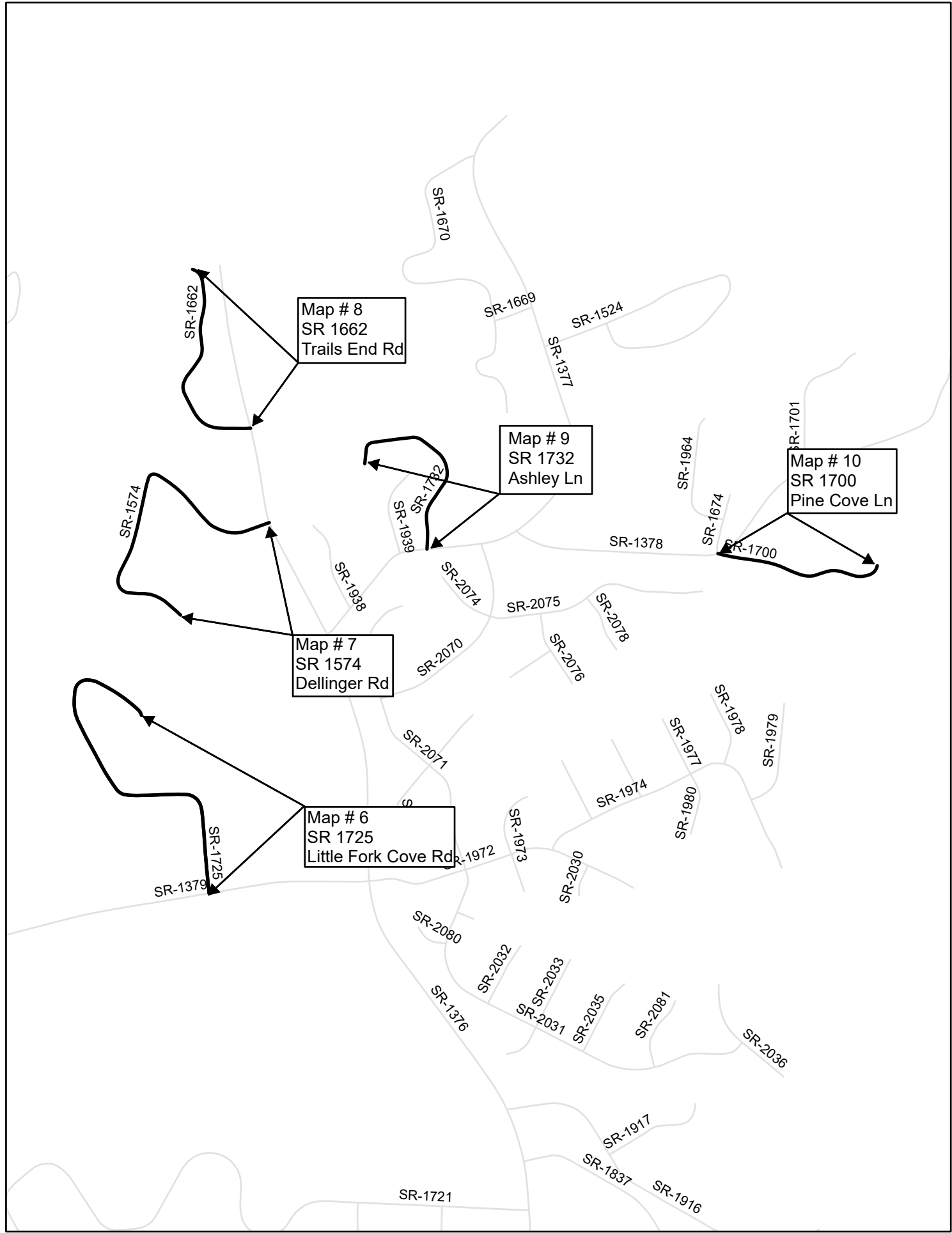

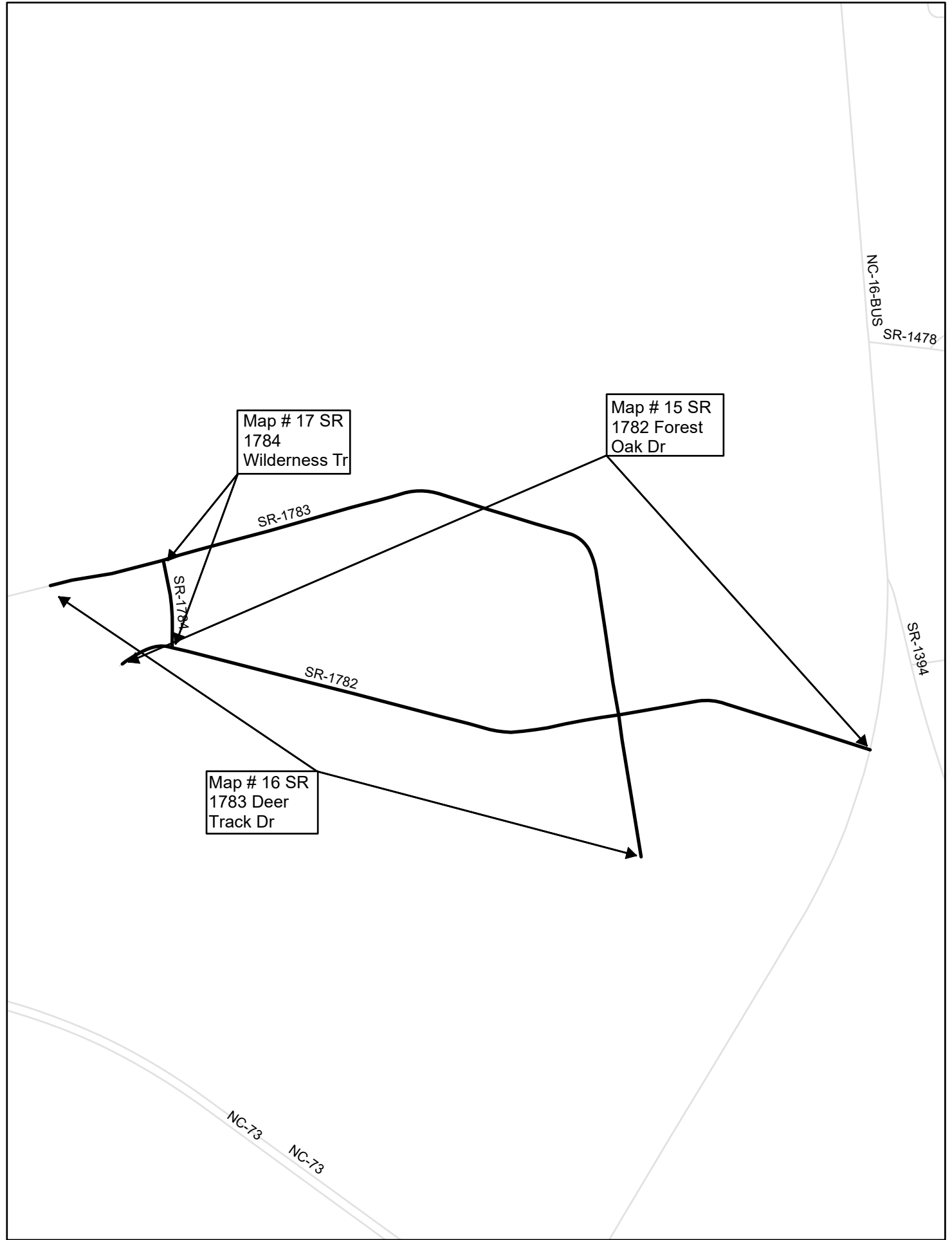
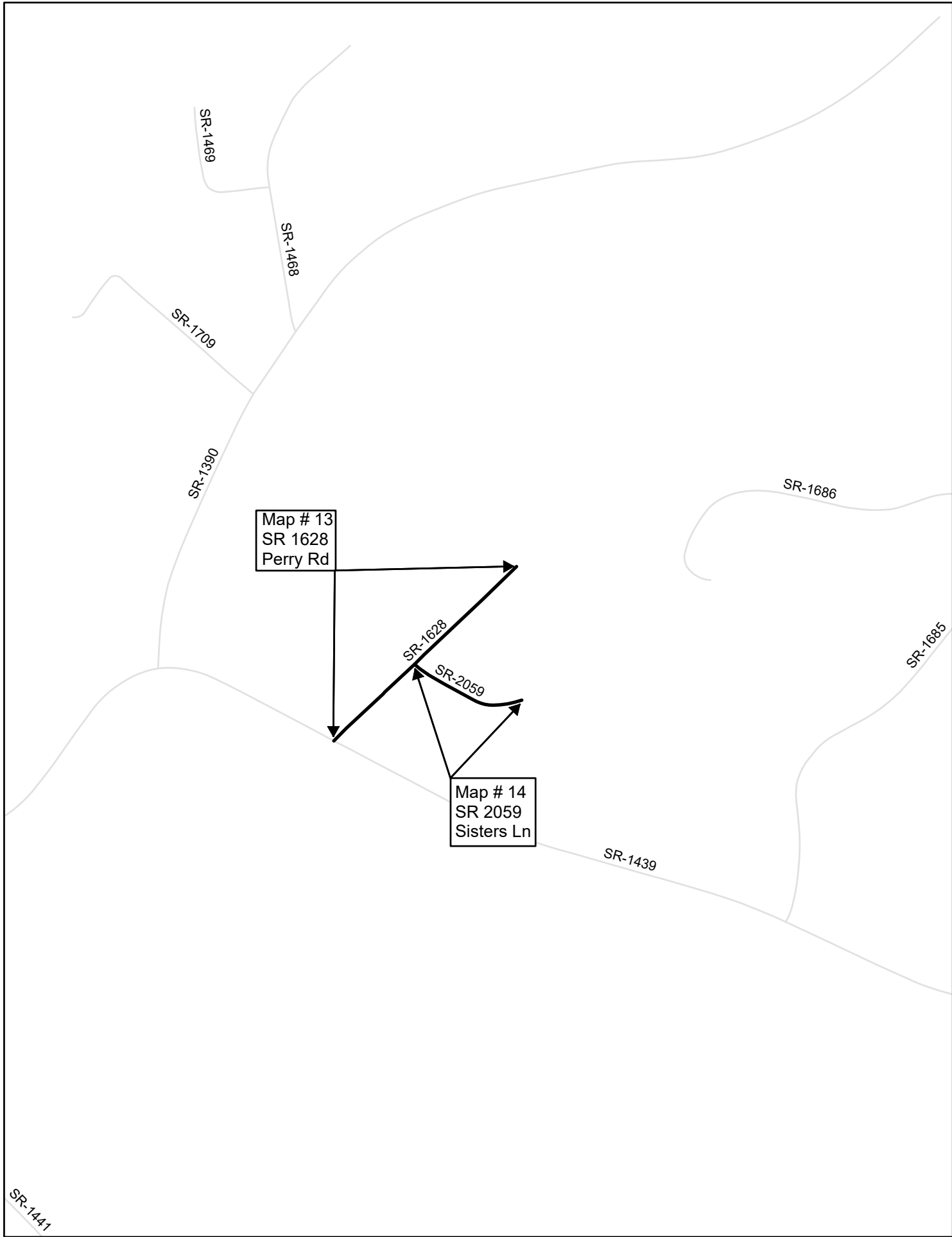

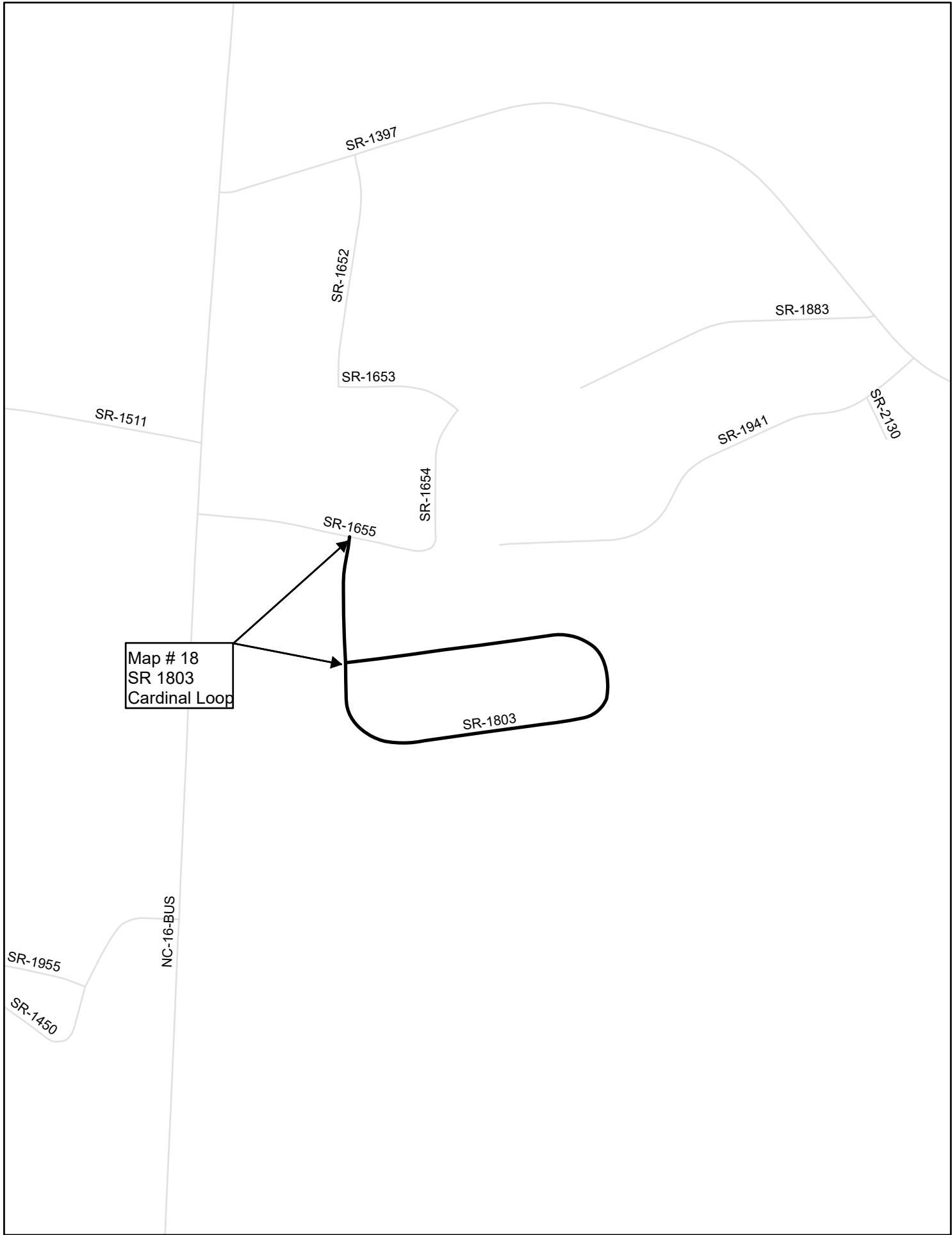

STATE	PROJECT WBS	SHEET NUMBER
NC	2025CPT.12.17.20552	6

PAVEMENT SCHEDULE	
C1	PROP. APPROX. 1" ASPHALT CONCRETE SURFACE COURSE, TYPE S4.75A, AT AN AVERAGE RATE OF 110 LBS. PER SQ. YD.

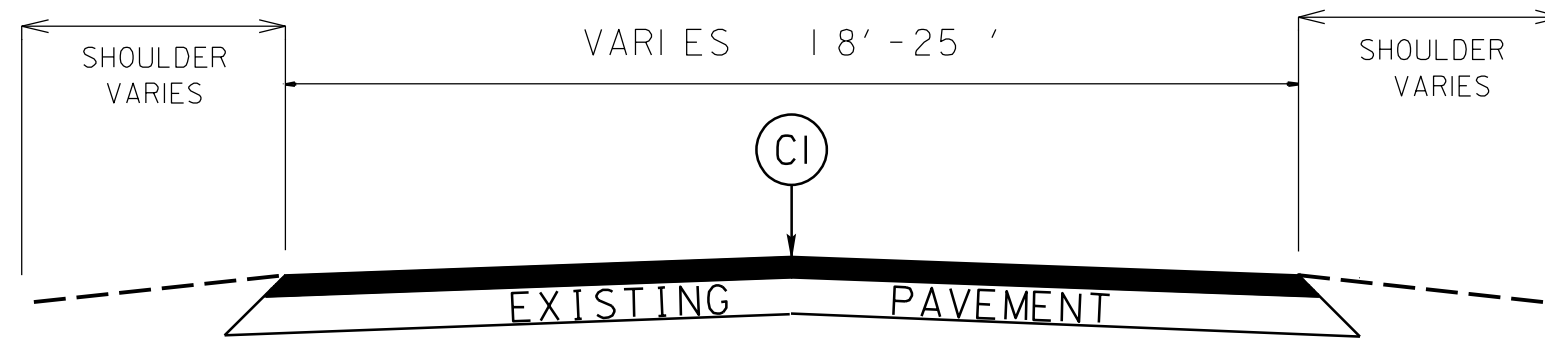

TYPICAL SECTION NO. 1

DETAIL A
PARTIAL DEPTH PAVMENT REPAIR

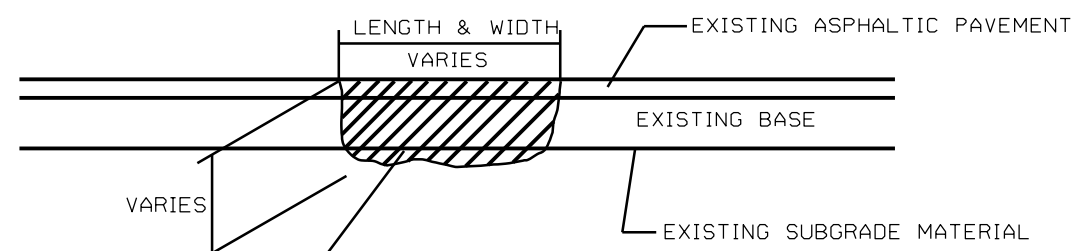

MILL EXISTING ASPHALT PAVEMENT AND REMOVE EXISTING LOOSE BASE AND/OR SUBGRADE MATERIAL AND REPLACE WITH ACSC AS DIRECTED BY THE ENGINEER

**TYPICAL SECTIONS
LINCOLN COUNTY 24-25'**

PROJECT NO.	SHEET NO.	TOTAL NO.
2024CPT.12.17.20552		

SUMMARY OF QUANTITIES

PROJECT NO	COUNTY	MAP NO	ROUTE	DESCRIPTION	TYP NO	LANES	LANE TYPE	FINAL SURFACE TESTING REQUIRED	WARM MIX ASPHALT REQUIRED	LENGTH	WIDTH	BEGIN MP	END MP	152600000-E	157500000-E	188000000-E	
														ASPHALT CONC SURFACE COURSE, TYPE S4.75A	ASPHALT BINDER FOR PLANT MIX	PARTIAL DEPTH PAVEMENT REPAIR	
										MI	FT				TON	TONS	TONS
2024CPT.12.17.20552	Lincoln	1	SR-1609 / EXECUTIVE CIR	FROM SR 1373 (CAMPGROUND RD) TO SR 1609 (EXECUTIVE CIR)	1	2	2WD	NO	NO	1.2	18	0	1.2	735	66	300	
2024CPT.12.17.20552	Lincoln	2	SR-2133 / BORDEAUX DR	FROM SR 1375 (PINE RIDGE DR) TO CUL-DE-SAC	1	2	2WD	NO	NO	0.49	20	0	0.49	343	31	150	
2024CPT.12.17.20552	Lincoln	3	SR-2134 / BURGUNDY LN	FROM SR 2133 (BORDEAUX DR) TO CUL-DE-SAC	1	2	2WD	NO	NO	0.11	20	0	0.11	77	7	40	
2024CPT.12.17.20552	Lincoln	4	SR-1682 / WILDWOOD TR	FROM SR 1373 (FORNEY HILL RD) TO CUL-DE-SAC	1	2	2WD	NO	NO	0.52	25	0	0.52	442	44	270	
2024CPT.12.17.20552	Lincoln	5	SR-1705 / HENDERSON ST	FROM SR 1682 (WILDWOOD TRL) TO CUL-DE-SAC	1	2	2WD	NO	NO	0.12	19	0	0.12	74	7	40	
2024CPT.12.17.20552	Lincoln	6	SR-1725 / LITTLE FORK COVE RD	FROM SR 1379 (WEBBS RD) TO CUL-DE-SAC	1	2	2WD	NO	NO	0.65	20	0	0.65	442	35	80	
2024CPT.12.17.20552	Lincoln	7	SR-1574 / DELLINGER RD	FROM SR 1376 (BURTON LN) TO END MAINT	1	2	2WD	NO	NO	0.58	18	0	0.58	400	28		
2024CPT.12.17.20552	Lincoln	8	SR-1662 / TRAILS END RD	FROM SR 1376 (BURTON LN) TO END MAINT	1	2	2WD	NO	NO	0.38	18	0	0.38	233	16		
2024CPT.12.17.20552	Lincoln	9	SR-1732 / ASHLEY LN	FROM SR 1377 (WEBBS CHAPEL CH RD) TO END MAINT	1	2	2WD	NO	NO	0.35	19	0	0.35	226	20	95	
2024CPT.12.17.20552	Lincoln	10	SR-1700 / PINE COVE LN	FROM SR 1378 (MCCONNELL RD) TO CUL-DE-SAC	1	2	2WD	NO	NO	0.3	19	0	0.3	194	17	80	
2024CPT.12.17.20552	Lincoln	11	SR-1619 / LAKE SHORE RD N	FROM SR 1389 (FAIRFIELD FOREST RD) TO SR 1389 (FAIRFIELD FOREST RD)	1	2	2WD	NO	NO	0.45	20	0	0.45	306	41	400	
2024CPT.12.17.20552	Lincoln	12	SR-1620 / BORDER CREEK CT	FROM SR 1619 (LAKE SHORE RD N) TO CUL-DE-SAC	1	2	2WD	NO	NO	0.15	19	0	0.15	97	8	20	
2024CPT.12.17.20552	Lincoln	13	SR-1628 / PERRY RD	FROM SR 1439 (UNITY CHURCH RD) TO END MAINT	1	2	2WD	NO	NO	0.22	18	0	0.22	135	9		
2024CPT.12.17.20552	Lincoln	14	SR-2059 / SISTERS LN	FROM SR 1628 (PERRY RD) TO CUL-DE-SAC	1	2	2WD	NO	NO	0.1	19	0	0.1	65	8	80	
2024CPT.12.17.20552	Lincoln	15	SR-1782 / FOREST OAK DR	FROM NC 16 BUS TO CUL-DE-SAC	1	2	2WD	NO	NO	0.68	19	0	0.68	452	46	300	
2024CPT.12.17.20552	Lincoln	16	SR-1783 / DEER TRACK DR	FROM CUL-DE-SAC TO CUL-DE-SAC	1	2	2WD	NO	NO	0.77	19	0	0.77	522	42	120	
2024CPT.12.17.20552	Lincoln	17	SR-1784 / WILDERNESS TR	FROM SR 1782 (FOREST OAK DR) TO SR 1783 (DEER TRACK DR)	1	2	2WD	NO	NO	0.07	19	0	0.07	45	4	20	
2024CPT.12.17.20552	Lincoln	18	SR-1803 / CARDINAL LOOP	FROM SR 1655 (LOWESVILL LN) TO SR 1803 (CARDINAL LOOP)	1	2	2WD	NO	NO	0.67	18	0	0.67	410	33	95	
TOTAL FOR PROJ NO. 2024CPT.12.17.20552										7.81				5,198	462	2,090	
GRAND TOTAL										7.81				5,198	462	2,090	

PROJECT NO.	SHEET NO.	TOTAL NO.
2024CPT.12.17.20552		

THERMOPLASTIC AND PAINT QUANTITIES

PROJECT NO	COUNTY	MAP NO	ROUTE	DESCRIPTION	TYP NO	LANES	LANE TYPE	LENGTH	WIDTH	BEGIN MP	END MP	441300000-E	445700000-N	481000000-E	481000000-E
								MI	FT			WORK ZONE ADVANCE GENERAL WARNING	TEMP TRAFFIC CONTROL	PAINT PAVEMENT MARKINGS, 4" WHITE	PAINT PAVEMENT MARKINGS, 4" YELLOW
												SF	LS	LF	LF
2024CPT.12.17.20552	Lincoln	1	SR-1609 / EXECUTIVE CIR	FROM SR 1373 (CAMPGROUND RD) TO SR 1609 (EXECUTIVE CIR)	1	2	2WD	1.2	18	0	1.2	24	*		
2024CPT.12.17.20552	Lincoln	2	SR-2133 / BORDEAUX DR	FROM SR 1375 (PINE RIDGE DR) TO CUL-DE-SAC	1	2	2WD	0.49	20	0	0.49	48	*		
2024CPT.12.17.20552	Lincoln	3	SR-2134 / BURGUNDY LN	FROM SR 2133 (BORDEAUX DR) TO CUL-DE-SAC	1	2	2WD	0.11	20	0	0.11		*		
2024CPT.12.17.20552	Lincoln	4	SR-1682 / WILDWOOD TR	FROM SR 1373 (FORNEY HILL RD) TO CUL-DE-SAC	1	2	2WD	0.52	25	0	0.52	24	*		
2024CPT.12.17.20552	Lincoln	5	SR-1705 / HENDERSON ST	FROM SR 1682 (WILDWOOD TRL) TO CUL-DE-SAC	1	2	2WD	0.12	19	0	0.12		*		
2024CPT.12.17.20552	Lincoln	6	SR-1725 / LITTLE FORK COVE RD	FROM SR 1379 (WEBBS RD) TO CUL-DE-SAC	1	2	2WD	0.65	20	0	0.65	24	*		
2024CPT.12.17.20552	Lincoln	7	SR-1574 / DELLINGER RD	FROM SR 1376 (BURTON LN) TO END MAINT	1	2	2WD	0.58	18	0	0.58	24	*		
2024CPT.12.17.20552	Lincoln	8	SR-1662 / TRAILS END RD	FROM SR 1376 (BURTON LN) TO END MAINT	1	2	2WD	0.38	18	0	0.38	24	*		
2024CPT.12.17.20552	Lincoln	9	SR-1732 / ASHLEY LN	FROM SR 1377 (WEBBS CHAPEL CH RD) TO END MAINT	1	2	2WD	0.35	19	0	0.35	24	*		
2024CPT.12.17.20552	Lincoln	10	SR-1700 / PINE COVE LN	FROM SR 1378 (MCCONNELL RD) TO CUL-DE-SAC	1	2	2WD	0.3	19	0	0.3	24	*		
2024CPT.12.17.20552	Lincoln	11	SR-1619 / LAKE SHORE RD N	FROM SR 1389 (FAIRFIELD FOREST RD) TO SR 1389 (FAIRFIELD FOREST RD)	1	2	2WD	0.45	20	0	0.45	72	*	9500	9500
2024CPT.12.17.20552	Lincoln	12	SR-1620 / BORDER CREEK CT	FROM SR 1619 (LAKE SHORE RD N) TO CUL-DE-SAC	1	2	2WD	0.15	19	0	0.15		*		
2024CPT.12.17.20552	Lincoln	13	SR-1628 / PERRY RD	FROM SR 1439 (UNITY CHURCH RD) TO END MAINT	1	2	2WD	0.22	18	0	0.22	24	*		
2024CPT.12.17.20552	Lincoln	14	SR-2059 / SISTERS LN	FROM SR 1628 (PERRY RD) TO CUL-DE-SAC	1	2	2WD	0.1	19	0	0.1		*		
2024CPT.12.17.20552	Lincoln	15	SR-1782 / FOREST OAK DR	FROM NC 16 BUS TO CUL-DE-SAC	1	2	2WD	0.68	19	0	0.68	24	*		
2024CPT.12.17.20552	Lincoln	16	SR-1783 / DEER TRACK DR	FROM CUL-DE-SAC TO CUL-DE-SAC	1	2	2WD	0.77	19	0	0.77		*		
2024CPT.12.17.20552	Lincoln	17	SR-1784 / WILDERNESS TR	FROM SR 1782 (FOREST OAK DR) TO SR 1783 (DEER TRACK DR)	1	2	2WD	0.07	19	0	0.07		*		
2024CPT.12.17.20552	Lincoln	18	SR-1803 / CARDINAL LOOP	FROM SR 1655 (LOWESVILL LN) TO SR 1803 (CARDINAL LOOP)	1	2	2WD	0.67	18	0	0.67	24	*		
TOTAL FOR PROJ NO. 2024CPT.12.17.20552								7.81				360	1	9500	9500
GRAND TOTAL								7.81				360	1	9500	9500
												19000			

SIGNING FOR RESURFACING PROJECTS

LEGEND
 ┆ STATIONARY SIGN
 ← DIRECTION OF TRAFFIC FLOW

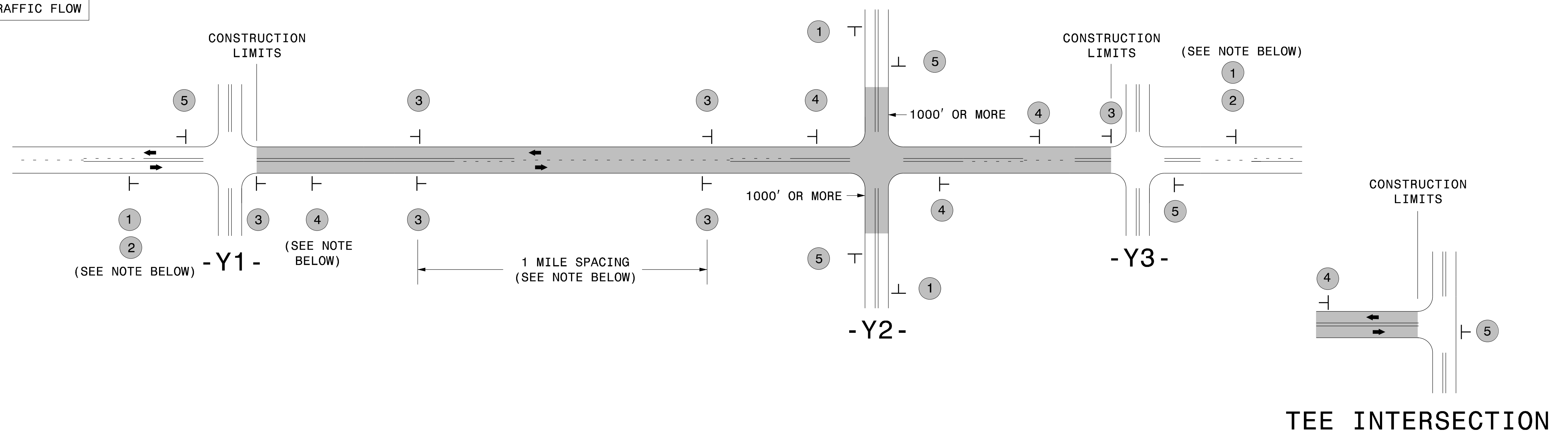

MAINLINE (-L-) SIGNING

-Y- LINE SIGNING

SIGNING NOTES AND PLACEMENT PER DIRECTION	1		PLACE 1000' PRIOR TO BEGINNING OF CONSTRUCTION LIMITS. ONLY USED ON -Y- LINES IF RESURFACING LIMITS EXTEND 1000' ALONG -Y- LINE.	<p>NO REQUIRED STATIONARY SIGNING FOR THE FOLLOWING -Y- LINE CONDITIONS:</p> <ol style="list-style-type: none"> 1) LESS THAN 1000' OF RESURFACING ALONG -Y- LINE 2) SUBDIVISION ROADS 3) DEAD END ROADS <p>WHEN PAVING/CONSTRUCTION ACTIVITIES PROCEED ACROSS AN UNSIGNED -Y- LINE, PORTABLE ADVANCE WARNING SIGNS SHALL BE USED ALONG THE -Y- LINE AS SHOWN BELOW. REMOVE UPON COMPLETION OF WORK.</p> <div style="display: flex; justify-content: space-around;"> <div style="text-align: center;"> W20-1 48" X 48" PLACED 500' IN ADVANCE OF FLAGGER. </div> <div style="text-align: center;"> W20-7 A 48" X 48" PLACED 250' IN ADVANCE OF FLAGGER. </div> </div>
	2		#2 SIGN ONLY USED WHEN CONSTRUCTION LIMITS ARE 2 OR MORE MILES IN LENGTH. ROUND UP TO NEXT WHOLE NUMBER. (NO FRACTIONAL OR DECIMAL NUMBERS)	
	3		- PLACE INITIALLY AT THE CONSTRUCTION LIMITS AND SPACE 1 MILE APART THEREAFTER. - AT TEE INTERSECTIONS INSTALL INITIALLY 1/2 MILE FROM INTERSECTION AND SPACE 1 MILE APART THEREAFTER.	
	4		- THESE ARE FOR -Y- LINES THAT ARE "THROUGH" ROADWAYS. - DEAD END AND SUBDIVISION ROADS ARE NOT "THROUGH" ROADWAYS. - INSTALL 500' +/- FROM EACH -Y- LINE APPROACH AS SHOWN ABOVE. - FOR MULTIPLE -Y- LINES THAT ARE SEPARATED BY 0.25 MILES OR LESS, TREAT AS A SINGLE UNIT AND INSTALL WITHIN 500' OF EACH APPROACH. - A MAXIMUM OF 2 SIGN SETS PER MILE. DO NOT INSTALL WHEN -Y- LINES ARE WITHIN 0.5 MILES FROM "END ROAD WORK" SIGN. - FOR TEE INTERSECTIONS, INSTALL WITHIN 500' +/- OF THE INTERSECTION ALONG -L- LINE.	
	5		PLACE 500' FOLLOWING THE END OF CONSTRUCTION LIMITS OR AS SHOWN WHEN WORK ENDS AT A 3-WAY TEE INTERSECTION.	

THE ABOVE SIGNS ARE ALL THAT ARE REQUIRED FOR A CONTRACTOR TO BEGIN A RESURFACING CONTRACT. ANY ADDITIONAL SIGNS REQUESTED BY NCDOT DIVISIONS SHALL BE INSTALLED WITHIN 7 BUSINESS DAYS OF THE START OF CONTRACT WORK.

MAPS LESS THAN 2 MILES

FOR RESURFACING MAPS WITH CONSTRUCTION LIMITS LESS THAN 2 MILES IN LENGTH, NO STATIONARY SIGNS ARE REQUIRED. USE PORTABLE "ROAD UNDER CONSTRUCTION" OR "ROAD WORK AHEAD" SIGNS IN LIEU OF STATIONARY ADVANCE WARNINGS SIGNS.



ADVANCE WARNING SIGNS FOR RURAL AND SUBURBAN 2-LANE ROADWAY RESURFACING

5/15/2017 S:\TUXWZTC\Resurfacing\2L2W & AST Resurfacing Details\Resurfacing_AdvWarn_2Ln.dgn User:kadai